

# Leavenworth County Master Gardener Program

## Portfolio



### Butterfly Garden—500 Eisenhower Rd, Leavenworth, KS

Our purpose is to provide the plants and habitat for pollinators, especially Monarch Butterflies. Monarch butterfly populations are declining and it is important to make people aware of the need to provide pesticide free host plants and habitat to help them. In September we have an Open House during the annual Monarch migration. We tag butterflies and send them on their way to Mexico for the winter. The garden is open to the public daily.

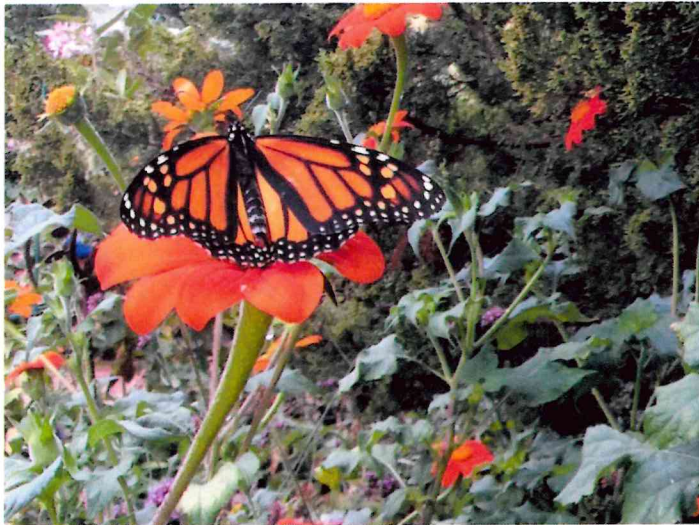

## Basehor Elementary Garden—15602 Leavenworth Rd, Basehor, KS

The Basehor Elementary garden was started in 2017 as an interactive educational garden for the children in school and the Basehor elementary School. It is also a Monarch way station garden.





## Basehor Library Garden—1400 158th St. Basehor, KS

The Basehor Library garden was taken over by Leavenworth County Master Gardeners in 2015 and transformed into an educational and Monarch Way station garden.

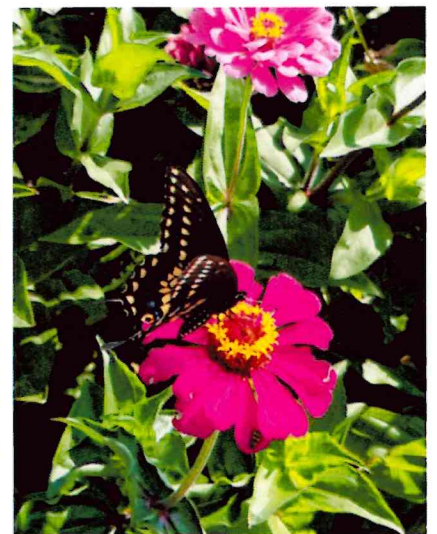



## Herb Garden— Carroll Mansion, 1128 5th Ave. Leavenworth, KS

The herb garden is part of Carroll Mansion. The brick walk takes you around an old fashion garden wheel herb bed. The garden is also made up of individual specialty gardens including kitchen, cottage, heirloom, salad, fragrance, tea, butterfly and medicine beds.

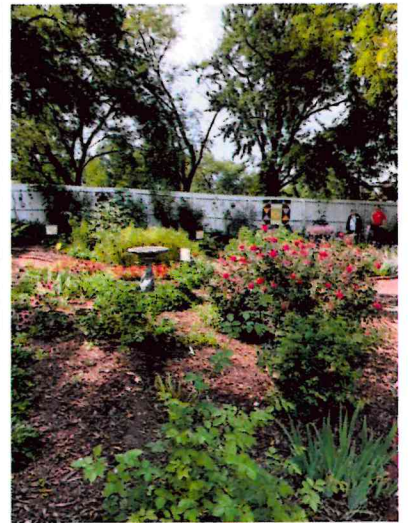



## Lansing Library Garden - 730 1st Terrace #1, Lansing, KS

This small garden brings nature to the parking lot, provides educational opportunities, and serves as a Monarch Waystation.





## Leavenworth Library Garden , 417 Spruce Streer , Leavenworth, KS

The garden serves as a Monarch Waystation. It provides nectar plants for monarch butterflies and host plants for caterpillars to munch on for their development into butterflies.





## Magnatech Park Garden - Co Rd 5, Tonganoxie, KS

This park borders walking trails and other community parks and provides opportunities to sit on benches and enjoy nature. The city mows the grass while master gardeners maintain the gardens. The high schoolers also come out each year to help with mulching and planting annuals in the spring. The garden also serves as a Monarch Waystation and popular backdrop for special occasion photos.



## 4-H Horticulture Judging

Started in 2015, this project was set up to facilitate the participation of 4-Her's. The contest is a qualifying event for the state 4-H Horticulture Judging Contest. 4-H horticulture judging consists of a general garden knowledge written test, plant identification, and quality judging. Kids also participate in K-State's soybean growing contest and field trips.







## Delaware and Landing Park Project

Master gardeners help beautify the city of Leavenworth each year by planting the stone planters along Delaware Street as well as the beds and planters at the Riverfront Community Center.





## Fairgrounds Native Garden - 405 W 4th St, Tonganoxie, KS

This project garden is located at the Tonganoxie Fairgrounds and features all native plants and a beautiful gazebo to enjoy the area.





## **Leavenworth County Fair Display - 405 W 4th St, Tonganoxie, KS**

The Leavenworth County Master Gardeners man a display in the administrative building during the fair. The have many educational posters set up and are available to answer horticulture questions. They also host a variety of informative programs during fair week.